

INSTALLATION INSTRUCTIONS

1. ENSURE THE APERTURE IS CLEAN AND FREE OF DEBRIS. REMOVE DUST FROM SURFACES REQUIRING INSTALLATION.
2. CUT FIRE THERM ABLATIVE COATED INTUBATT TO THE REQUIRED SIZE AND SHAPE, ENSURING THE INTUBATT WILL OVERLAP THE PLASTERBOARD 75MM AROUND THE OPENING.
3. CUT THE INTUBATT TO ALLOW 10MM-30MM ANNULAR AROUND THE PEX PIPE.
4. CUT THE INTUBATT ACROSS THE SHORTEST DIMENSION INCORPORATING THE MIDPOINT OF THE PENETRATION, TO ENABLE THE INTUBATT TO BE FITTED ON TO THE PLASTERBOARD.
5. APPLY FIRE RATED INTUMASTIC TO PLASTERBOARD WHERE THE INTUBATT IS TO BE FITTED TO BOND INTUBATT TO PLASTERBOARD AND INTUBATT TO INTUBATT.
6. FIRMLY PRESS INTUBATT TO PLASTERBOARD TO ENSURE BOND.
7. FIX THE INTUBATT TO THE PLASTERBOARD USING MINIMUM 75MM LONG STEEL SCREWS AND 25MM DIAMETER STEEL WASHERS. FIXINGS SHOULD NOT EXCEED 50MM FROM ANY EDGE AND NOT EXCEED 200MM CENTRES.
8. APPLY INTUMASTIC HP AROUND PEX PIPE, FULL THICKNESS OF THE INTUBATT SEAL.
9. APPLY A FILLET OF FIRE RATED INTUMASTIC TO APPROXIMATELY 10MM WIDE AROUND THE OUTSIDE OF THE INTUBATT WHERE IT MEETS THE PLASTERBOARD. ENSURE THAT ALL GAPS BETWEEN INTUBATT AND THE SURROUNDING EDGES ARE FULLY SEALED.
10. REPAIR ANY DAMAGES TO THE COATING WHICH MAY HAVE OCCURRED DURING INSTALLATION AND OVERCOAT EXPOSED FIXINGS AND EXPOSED MINERAL FIBRE USING INTUMASTIC BRUSH OR SPRAY GRADE.
11. REPEAT THE ABOVE TO THE OPPOSITE SIDE OF WALL.

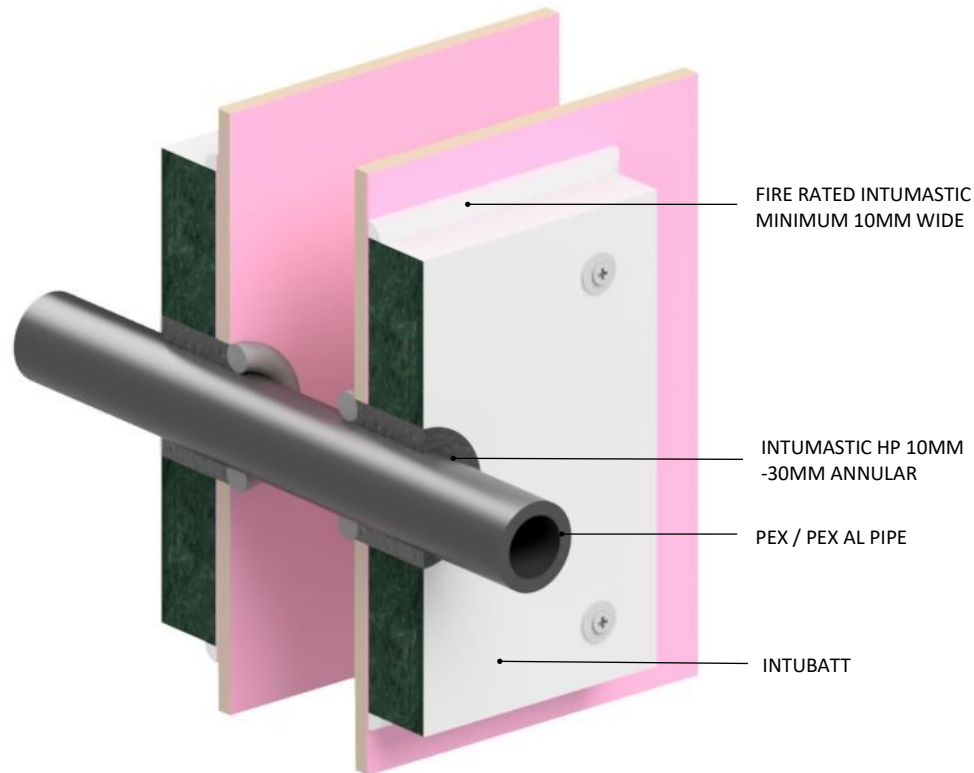

Products: INTUBATT, INTUMASTIC HP
Approvals: AS 1540.4/AS 4072.1
BK: 35
Ref: 34088500
ID: V55, V57, V68, V69
Scenario: PEX / PEX AL pipe passing through fire wall.
Penetrations: 16mm- 43mm dia.
Construction: Gypsum/Masonry fire wall
Fire Integrity: 60 minutes.
Insulation: 60 minutes.

Web based drawings are for example only, fire performance of any system is dependant on, but not limited to size of opening, substrate, if penetrations are passing through, type, size and number. Please refer to Ryanfire technical department for detailed and specific fire performance information.



Client

Job Title

Drawing Title
Intubatt Seal to PEX-Pipe

Scale	Date	
NTS	July 2019	
Sheet Size	Drawn By	
A3		
Drawing Number	Rev	
V20.6	2.0	

Please note:
 Ryanfire Products Ltd owns and has copyright in these drawings. They are to be used only for the purpose for which they were intended and supplied and are not to be sold, transferred or made available for use by a third party.
 Any misuse of these drawings will result in legal proceedings.

All errors and omissions excepted - the Information contained within this drawing is believed to be correct on the date of publication, and is based upon tested and certified solutions. The policy of **RyanFire Products Ltd** is one of constant improvement. Installers must therefore ensure that they are following the latest published drawings, test evidence and instructions. Whilst **RyanFire Products Ltd** will endeavour to keep its publications up to date, the accuracy of the information contained within this drawing may be affected by pertinent changes in the law or regulatory requirements and alterations or amendments to the specification of the **manufactured** products. Terms and conditions of sale apply.

RYANFIRE Technical Support: info@ryanfire.co.nz- Tel 09 443 0362